

REVISIONS			
Rev.	Modification	Date	Done By
0	Original	11/30/2016	WAS
A	Added Minimum Indicator Flow Rate	10/3/2018	WAS

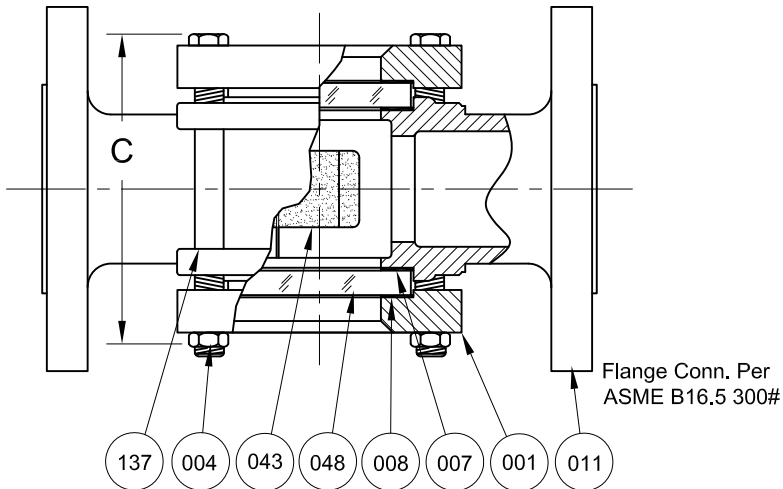
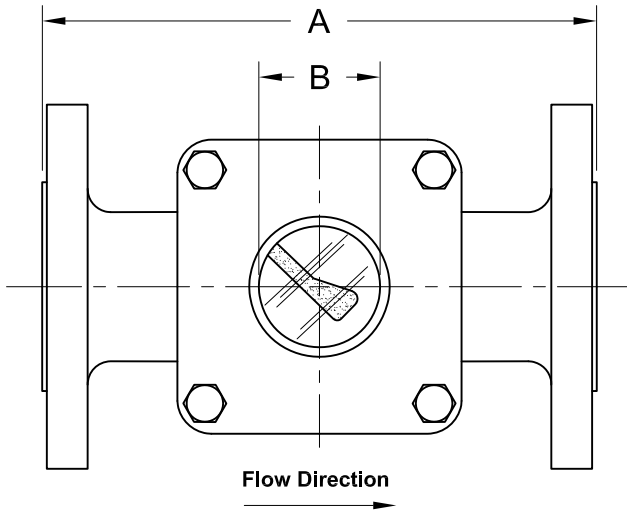

BILL OF MATERIALS						
* - Denotes an Optional, Non-Standard Material						
No.	Name of Part	Qty.	Material	Max. Temp. (°F)	Material Grade/Notes	
Wetted	011	1	Carbon Steel		ASTM A-216 WCB	
			316SS		ASTM A-351 CF8M	
	007	2	Neoprene	250		
			Gylon®	500	Gylon® 3504	
			*EPDM	250		
			*Viton®	350		
			*Graphite	500		
048	2	*Non Asbestos	500	Klinger C-4400		
		*Buna-N	250			
043	Flapper Assembly	1	316SS			
Non-Wetted	008	Cushion	2	Non-Asbestos	500	Klinger C-4400
	001	2	Steel		ASTM A-216 WCB	
			316SS		ASTM A-351 CF8M	
	137	4	Plated Steel		SAE Gr. 5	
			*316SS		ASTM A193-B8M	
004	4	Plated Steel		SAE Gr. 5		
		*316SS		ASTM A194-8M		

KEY NOTES:

1. Retainers are the Same Material as the Body
2. For NACE Compliance, Please Inquire

PRODUCT SPECIFICATIONS										
Flange Size	A		B		C		Weight		Rating	1st Rate of Indication
	In.	mm.	In.	mm.	In.	mm.	lbs.	kg.	PSIG	GPM
8	23	584	6-7/8	175	16-1/4	413	250	113.4	300	42.0

***8" Units are 300 PSIG Max**

S16FC Series Configuration Choices:

Reference the Series S16FC Model Number Matrix on our Website or Inquire with our Sales Team

Gylon® is a Registered Trademark of Garlock Sealing Technologies
 Viton® is a Registered Trademark of the Chemours Company

JOHN C ERNST LLC.		www.johnernst.com 21 Gail Ct. Sparta, N.J. USA		
				Series S16FC Sight Flow Indicator - Flapper 300# Flanged
Sheet 1 of 1	Drawn By WAS	Tolerances, unless otherwise noted Dec.: ± Frac.: ± Ang.: ±		Size: A
Scale: NTS	Approved By: JCW	Date: 03-OCT-18		Dwg. No.: SC2.S16FC.02.1.0
				Rev.: A